

No.	Art. No.	IFS megnevezés EN	Pcs
1	AKU1830	Filter house for floating 50 sqf filters	2
2	ACM0912	Control Panel - IN.K1000 V2	1
3	AKU1893	On-Off tap house 33 transparent V2	1
4	AKU1892	Air Regulator - house led lighted V2	2
5	AJ00169	Jet - 20 SB - Ozone 90°	1
6	AKU2157	Adapter for swim theter V2	1
7	ABE0505	Suction 2" chrome thick with seal V2	4
8	AJ00244	Sealing for self adjusting suction head nut	13
9	AJ00243	Self adjusting nut for suction head	13
10	AKU1720	Suction 48	2
11	ACM0874	Speaker 3" (2 way)	4
12	ACM0875	Grille for speaker 3" (2 way)	4
13	ABE0421	Suction 2" chrome thick	9
14	AE00658	Suction seal 2" 126x83 mm V2	9
15	AKU2625	Fountain laminar V3	6
16	AKU2218	Led housing with seal	18
17	AKU2219	Nut for ledhouse	18
18	ACM0080	Spa Pump 3 HP - One Speed	1
19	ACM0888	UV-C Stainless steel house set	1
20	ASE0079	Spring Clamp	2
21	ACM0834	Circulation pump PCF100 1100 W without prefilter	1
22	ACM0776		1
23	ASE0004-K		5
24	ASE0005-K		9
25	ASE0210		4
26	ASE0048-K		4
27	ABE0343		2
28	ABE0334		2
29	ABE0413	Counterflow housing	1
30	ACM0954	Motor 50Hz ellenáramoltató 2200W (WP300a-II)	3
31	AJ00214	Jet 2" - transparent 1 Hole transparent V3 Wellis	6
32	AJ00217	Jet 3" - transparent 1 Hole Rotation transparent V3 Wellis	18
33	AKU1896	On-off tap grip Wellis V2	1
34	AKU1832	Filter House - Skimmer Cover round	2
35	AKU1842	Skimmer house with Wellis logo	2
36	AKU1895	Air regulator grip Wellis V2	2
37	AF00061	Pillow 300x126x54 white ribbed	2
38	ACM0849	Subwoofer 288W	1
39	AF00045	Sidepanel pillow holder	4
40	ACM0998	IN.STREAM-2 with quick connector Sinkable to the ABS height	1

Sheet name: Danube - 2019 Wflow		Projection			
File name: FJ_WU00037_ENG_Danube-2019_Vflow_úszómedence					
Medence sz, h, m: 2350x4530x1470 mm		Elekt. ig. min.: 400 V - 3x16A - 50Hz / Elekt. ig. teljes: 400V - 3x20A - 50Hz			
1 személy ~75 kg		Medence súly: kg		Vezérlő: GECKO YT8 + K1000	
Vízkielvezés: 225 kg		Peremmagasság: 150 mm		Approved by: Losteiner Sándor	
Minimum víz: 5913 liter		Created: 2022. 02. 09.		Pr. No: P-00133	
		Drawer: losteiner.sandor - 2022. 01. 31. 15:40:37		Number: WU00037	
				A3 M 1:50 page 1 / 3	

You must install a 30 mA residual-current device (RCD).

INSTALLATION INSTRUCTIONS

Installation, connection and electrical installation can be done only by professionals!

The given dimensions are for information only, they can differ in reality than written on the drawings, due to the manufacturing technology of the pools.

ATTENTION!

Pools are installed only when electric shock protection compliance of the installed residual-current device is stated by the installation personnel in written form.

COMMISSIONING INSTRUCTIONS

1. Preparation of the area

a. Interior/Basement

In case of placing the pool inside a building take in consideration the following requirements: The base must have a proper drain channel to prevent water collecting around the pool.

If building a new place for the pool, it is strongly recommended to install a floor drain to prevent damage due to water overflow or mechanical failure, etc.

If no floor drain is installed, our Company takes no responsibility for occurring damages.

Inside the room, where the pool is installed, humidity can highly increase. To prevent precipitating water and occurrence of fungus, proper ventilation of the room is highly recommended.

It is recommended to install a dehumidifier device in the room.

b. Outdoor/Closed terrace

For proper installation of the pool, a **solid, horizontal** base is essential. Make sure that the pool is properly supported.

You must know the load capacity of the base.

Consult a specialist in architecture or a static engineer.

You can find the weight, contents and parts of the pool on the data table.

This weight should not exceed the calculated static capacity, otherwise damage can occur on the pool or base.

If the pool is installed outdoor, it is recommended to build a horizontal, reinforced concrete base with min. 10-15 cm thickness.

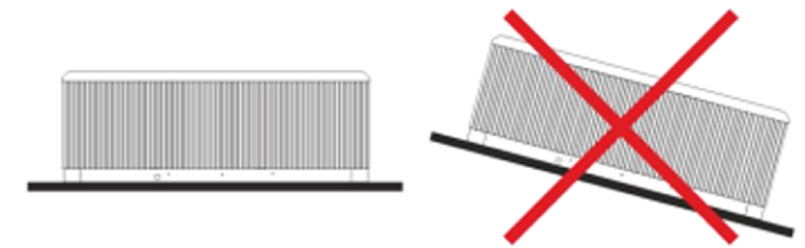

It is appropriate to make the drain channel in the base on the drain side of the pool. Its purpose is to take away splash water around the pool, or drain the released water.

It is also necessary to provide water drainage in the manhole.

The manhole should also ventilate properly. It is recommended to install an exhaust fan or other ventilation device.

Do not expose the empty pool to direct sunlight without adequate protection (pool cover). The long lasting sunlight can damage the surface of the pool or other accessories.

The acrylic surface quickly absorbs the heat from sunlight. Due to high surface temperature, the pool may be damaged.

In case the pool is installed between glass walls, prevent sunlight directly reaching the pool through the glass. Otherwise temperature can get very high.

2. Installation of the pool

When the pool is built-in (lowered into the ground), it is necessary to build a min. 60 cm wide manhole around the pool, to provide space for maintenance works.

When lowering the pool, **the acrylic side must be above the ground.** When not fulfilling these conditions, installation may fail!

The incurring cost of a possible lifting operation is borne by the customer!

3. Electrical installation

You must install a circuit breaker dedicated only for the pool, no other devices allowed to connect.

Cable length/cross-section specifications:

- Minimal demand: Until **10 m cable length: 1x16 A, 3x2.5 mm² cabling (230V)** - in this case the 3 HP motor and the heating CAN'T work simultaneously.

- Total demand: Until **10 m cable length: 1x25 A, 3x4 mm² cabling (230V)** - in this case the 3 HP motor and the heating CAN work simultaneously.

- If more than 10 m of cable is needed, consult a specialist.

- Installing the cables is recommended through the bottom cover (tray) by drilling a hole and using a cable gland. Recommended direction is shown on the drawing. Min. cable length for installation is 3 m.

- The exact way of electrical installation is always unique, highly dependant on the location and environment of the pool.

Additional electrical installation (cable, circuit breaker and residual-current device) is the customer's responsibility.

These parts are not included in the pool packaging, need to be purchased separately.

Every pool has a dedicated installation drawing.

Make sure that the pool is connected to a 30 mA residual-current device.

Use copper wiring only.

If a fuse fails, replace it only with same type of fuse with same technical parameters.

The device must be connected to the house's Equipotential Bonding Grid.

Product family: **SwimLine**

Sheet name: INFO		Projection			
File name: FJ_WU00037_ENG_Danube-2019_Vflow_úszómedence					
Dimension SPA: 2350x4530x1470 mm		Min.El. nds: 400 V - 3x16A - 50Hz / Opt.El. needs: 400V - 3x20A - 50Hz			
Weight of the SPA: kg		Rim height: 150 mm		Control box: GECKO YT8 + K1000	
Water disp.: 225 kg		Approved by: Losteiner Sándor		Pr. No: P-00133	
Minimum water: 5913 liter		Created: 2022. 02. 09.		Fe. No: WU00037	
		Drawer: losteiner.sandor - 2022. 01. 31. 15:40:37		Number: WU00037	
				A3	
				M 1:15	
				page 2 / 3	

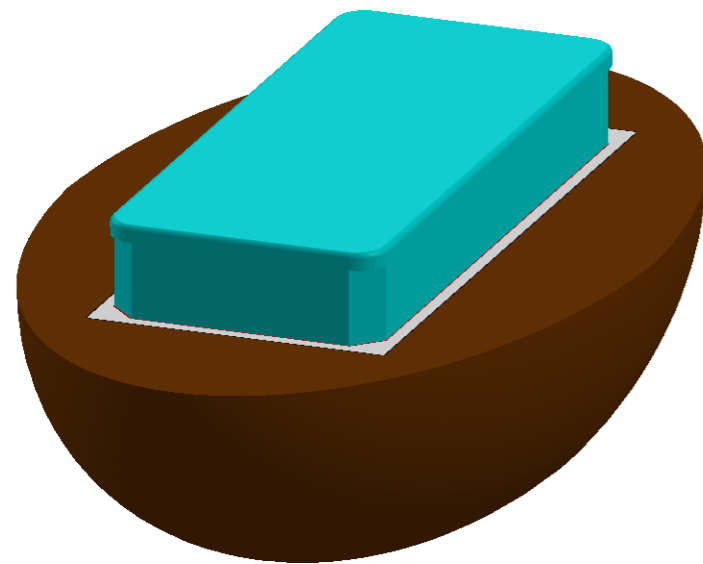
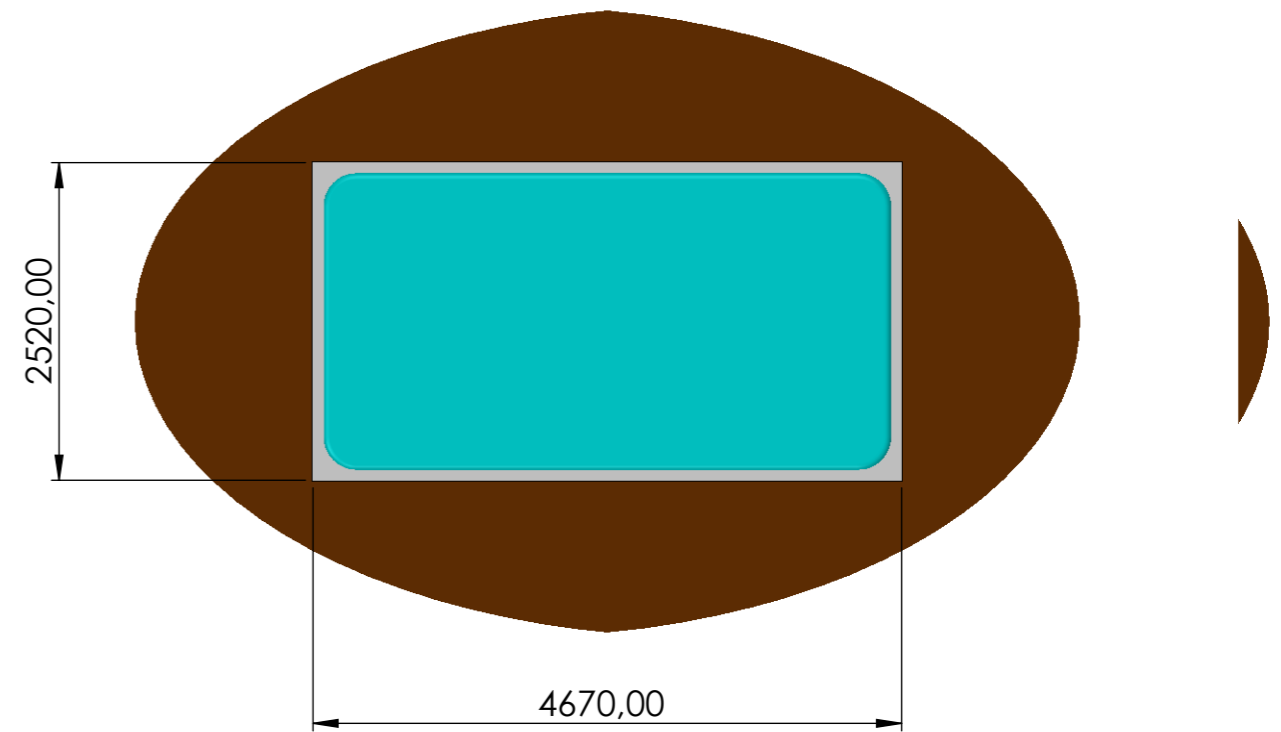
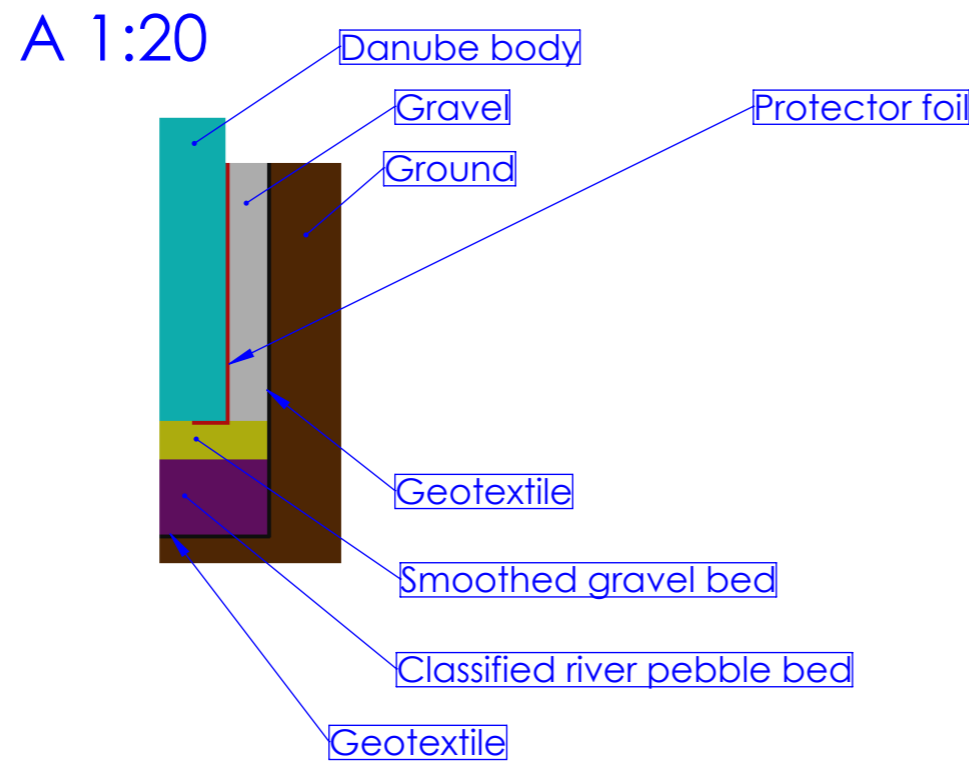
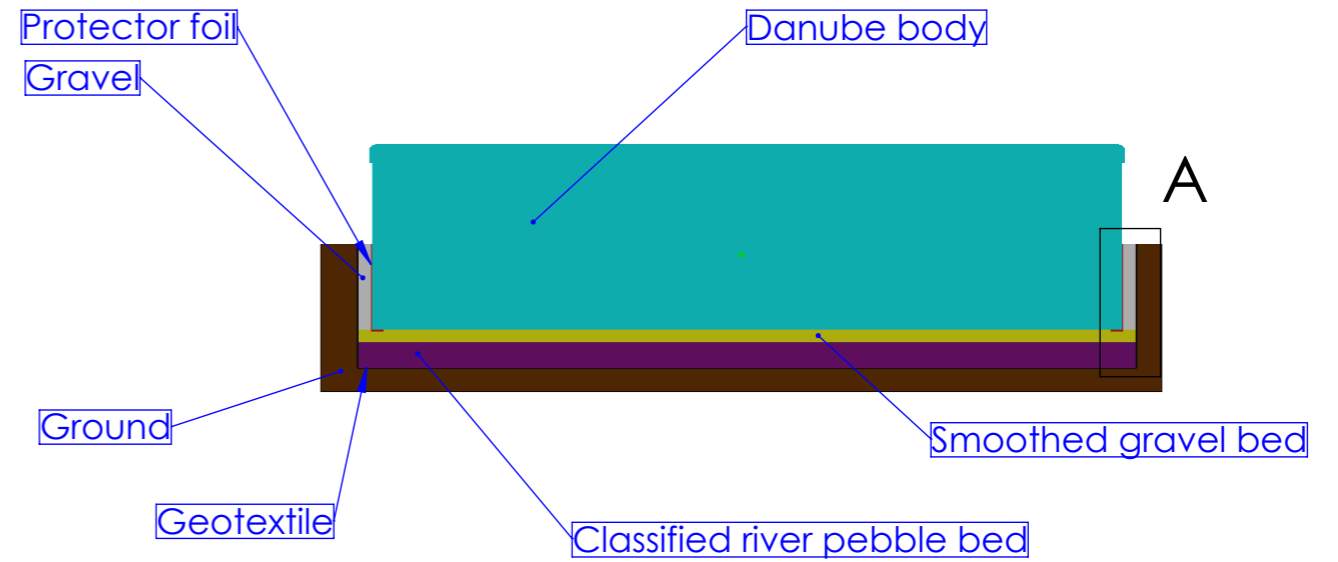
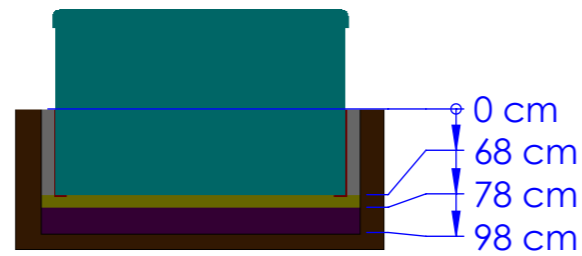

Product family: **SwimLine**

Sheet name: SEMICABINET		Projection			
File name: FJ_WU00037_ENG_Danube-2019_Vflow_úszómedence					
Dimension SPA: 2350x4530x1470 mm			Min.El. nds: 400 V - 3x16A - 50Hz / Opt.El. needs: 400V - 3x20A - 50Hz		
1 person ~75 kg		Weight of the SPA: kg		Control box: GECKO YT8 + K1000	
Water disp.: 225 kg		Rim height: 150 mm		Approved by: Losteiner Sándor	
Minimum water: 5913 liter		Created: 2022. 02. 09.		Pr. No: P-00133 Fe. No: WU00037	
		Drawer: losteiner.sandor - 2022. 01. 31. 15:40:37		Number: WU00037	
				A3 M 1:17 page 3 / 3	